



# THE WILLOW

70m<sup>2</sup> 753 sq ft

	m	ft
Living	3.4m x 4.4m	11'2" x 14'5"
Kitchen / Dining	4.4m x 3.4m	14'5" x 11'2"

	m	ft
Main bedroom	4.4m x 4.0m	14'5" x 13'1"
Bedroom 2	2.2m x 4.0m	7'3" x 13'1"

Note: Room sizes are indicative and for information purposes only.



Ground floor

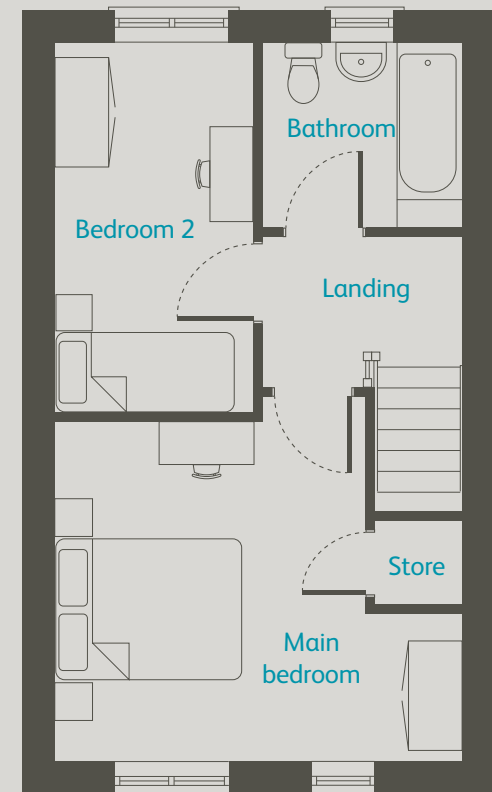

First floor

