

NEW DESIGNS & OFFER

FOR JUNIPER CRESCENT

**EXCITING
NEW DESIGNS
&
A GREAT NEW
OFFER FOR
YOU!**

**WE HAVE BRAND
NEW DESIGNS AND
AN UPDATED OFFER FOR
RESIDENTS.**

TO CELEBRATE THE LAUNCH, WE WILL HAVE
BURGERS, FACE PAINTING & MORE

**16TH OF JULY
12 - 3PM**

AT JUNIPER CRESCENT
GREEN & HUB

**VIEW THE
NEW DESIGNS &
OFFER FROM JULY
16TH TO AUGUST 13TH.**

See the openings hours
on the other side
of this flyer

**JOIN US AT THE
RESIDENTS' HUB
TO VIEW THE NEW
REDEVELOPMENT PLANS
& BRAND NEW RESIDENT
OFFER FOR JUNIPER
CRESCENT.**

We have the new designs to share with you including 3D-models and fly through footage of the proposed development as well as an updated offer on the things that were most important to you, including home sizes, costs and parking.

The team will be available to talk you through and answer any questions. Come along, we really want to know what you think!

**BETTER,
BRIGHTER
HOMES**



**UPDATED HOMES
DESIGNS**

New images, 3D models and
videos of your new home

**MORE
GREEN
SPACE**



NEW ESTATE DESIGNS

A greener, more sustainable
neighbourhood with better
private & shared space.

**10 YEAR
COST
GUARANTEE**



A BETTER OFFER

Improvements to the things
that were most important
to you!

**PERSONAL
SUPPORT**



MORE MOVING SUPPORT

How and when we will
support you through the
moving process.

JULY 2022

One Housing

Part of
Riverside

COUNTRYSIDE
Places People Love

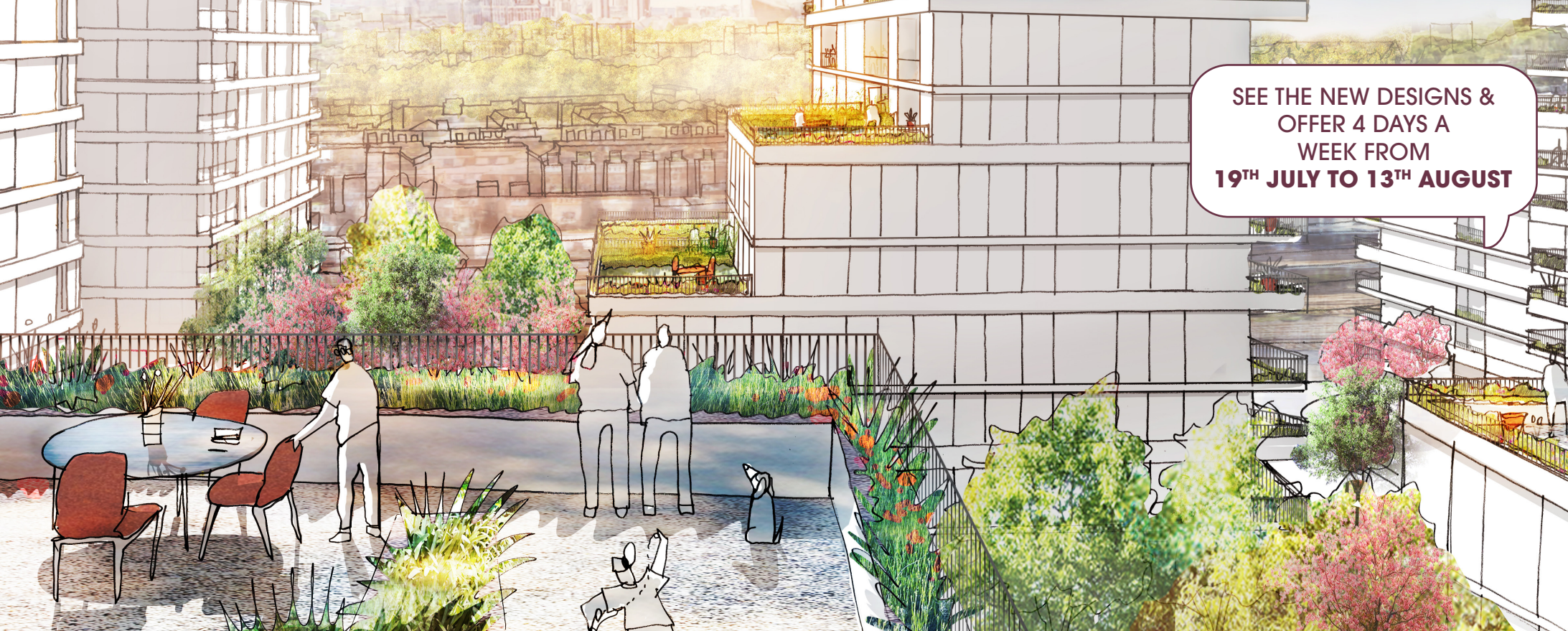

SEE THE NEW DESIGNS AND OFFER

We have plenty of opportunities for you to chat to the team and view the new proposals.

Got a specific question or want more detail? See the table to find out **WHO** will be at the hub daily and **WHAT** aspects of the designs and offer they specialise in.

FROM
TUESDAY
19TH
JULY

EVERY TUESDAY

12 - 4PM

WHO: The **One Housing engagement team**

WHAT: All topics relating to the regeneration or for general estate queries.

EVERY WEDNESDAY

12 - 3PM

WHO: One Housing team and award winning development partner, Countryside

WHAT: The new offer, design proposals, homes and future community.

EVERY THURSDAY

12 - 4PM

WHO: The **One Housing engagement team**

WHAT: All topics relating to the regeneration or for general estate queries.

EVERY SATURDAY

10AM - 1PM

WHO: One Housing team and award winning development partner, Countryside

WHAT: The new offer, design proposals, homes and future community.

4 - 8PM

WHO: Architects, PRP, & Independent Tenant Advisors (ITA), Communities First

WHAT: detail on the new designs & independent advice about the new offer.

4 - 8PM

WHO: Architects, PRP, & Independent Tenant Advisors (ITA), Communities First

WHAT: detail on the new designs & independent advice about the new offer.



WANT TO MEET ONE-TO-ONE?

Please contact us if you would you like to meet one-to-one with a member of the team to discuss the new designs and offer

WOULD YOU LIKE THIS INVITATION TRANSLATED?

மொழிபெயர்ப்பா? ترجمة?
অনুবাদ করা? 번역? অনুবাদ?
¿Traducción? Tarjumaad?
Werger? Tradução?



079666 43082



JUNIPERCRESCENT@ONEHOUSING.CO.UK

UPCOMING COMMUNITY FUN DAYS

SUMMER FEST & LAUNCH OF THE NEW PROPOSALS

BURGERS & SWEETS, FACE PAINTING & MORE

SAT 16TH JULY
12PM - 3PM

Juniper Crescent play area

CARNIVAL & END OF DESIGN MONTH

STEEL BAND, JAMAICAN FOOD, ZUMBA CLASS

SAT 13TH AUGUST
12PM - 3PM

Juniper Crescent play area

All events will have vegan, vegetarian & halal options!

